



SOFITEL

LUXURY HOTELS

MIAMI

The exquisite style blends the unique colors of the tropics with Art Deco design and sculpture, creating a contemporary ambiance that is as comfortable as it is captivating.

Sofitel Miami

5800 Blue Lagoon Drive
Miami, FL 33126

Telephone:305/264-4888
U.S. Toll-Free:800/SOFITEL
Fax:305/262-9049
Web:www.sofitel.com

Guest Room Information

Number of rooms:281
Number of suites:27
Number of floors:15
Check-in time:3 p.m.
Check-out time:12 noon

Meeting/Banquet Facilities

Sofitel Miami offers contemporary surroundings, state-of-the-art technology, superior food and beverage and a wide range of personalized services to achieve successful meetings and events.

Number of meeting rooms:10
Total square footage:11,223

Meeting Equipment

Audio/visual equipment, chairs, tables, lecterns, draping, flip charts, portable stage, teleconferencing, high speed internet access

Meeting Support Services

Spotlight technicians, electricians, transportation desk, business center, in-house audio/visual service, security guards, concierge

Dining and Entertainment

La Riviera—This upscale brasserie serves contemporary Mediterranean specialties with a Latin flair that reflects the culinary heritage of Miami. Open 6 a.m.–11:30 p.m.

Le Petit Marche—For a casual meal on the go, follow the smell of freshly baked bread to our own Parisian-style bakery. Now proudly serving Starbucks. Open 6 a.m.–2 p.m.

Le Bar—Located in the hotel's three-story atrium, this Art Deco-inspired lounge serves light lunches and dinners in addition to cocktails. Open 11 a.m.–1 a.m.

Guest Room Amenities

High speed internet access, luxury bath amenities, two-line phone with voice mail,

cable and pay movies, video check-out, individual climate control, electronic door locks, iron/ironing board, alarm clock, hair dryers.

Guest Services

Business center, concierge, gift shop, dry cleaning, laundry service, room service, valet parking, multilingual staff, ATM, ice machines, bell service, complimentary newspaper, currency exchange, roll-in showers (wheelchair-accessible), paid shuttle to Dolphin Mall, Bayside Marketplace and South Beach, complimentary shuttle to Miami International Airport (5 a.m.– 1 a.m.)

Recreational Facilities

Outdoor swimming pool with waterfall, overlooking Blue Lagoon; SoFit, a 24-hour health facility offers cardiovascular equipment and weight machines; two lighted tennis courts; jogging trail.

General Information

Credit Cards Accepted

American Express, Diners Club, Discover, MasterCard, Visa

Reservations

Best Unrestricted Rate: No deposit necessary; Cancel by 4 p.m. day of arrival.

Best Rate: Changes or cancellation may be made until 6 p.m. (hotel local time), one day prior to arrival.

Hot Deals: No change or cancellation may be made after booking. Guest Credit Card is charged for the amount of the entire stay upon booking.

Parking

Self parking—\$8
Valet parking—\$12

*Prices subject to change without notice

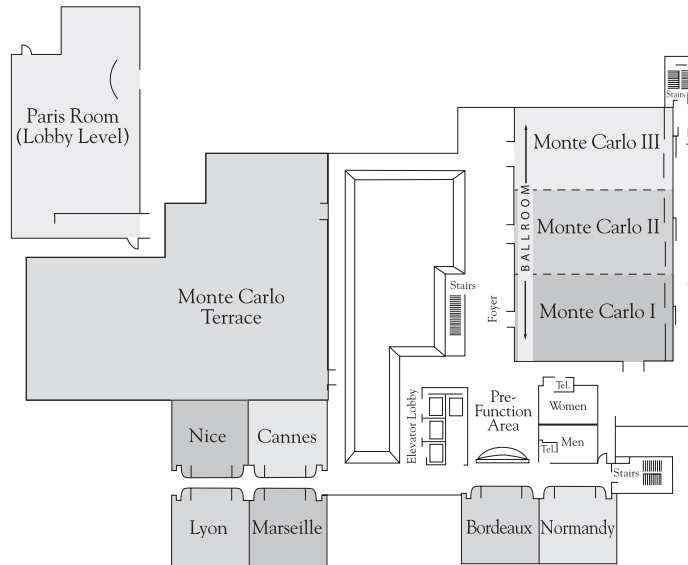

MEETING ROOM	DIMENSIONS (IN FEET)	SQUARE FEET	CEILING HEIGHT	MAXIMUM OCCUPANCY					
				BANQUET	RECEPTION	THEATER	CLASSROOM	CONFERENCE	U-SHAPE
Ballroom	51' x 93'	4,743	12'	380	700	-	300	-	-
Monte Carlo III	51' x 31.5'	1,606	12'	120	220	200	100	45	45
Monte Carlo II	51' x 30.5'	1,531	12'	120	220	200	100	45	45
Monte Carlo I	51' x 31.5'	1,606	12'	120	220	200	100	45	45
Normandy	26' x 24'	630	7'	-	-	-	-	-	18
Bordeaux	26' x 24'	630	7'	-	-	-	-	-	18
Marseille	26' x 24'	630	7'	-	-	-	-	-	18
Cannes	26' x 24'	630	7'	40	-	50	25	24	24
Lyon	26' x 24'	630	7'	-	-	-	-	16	-
Nice	26' x 24'	630	7'	30	-	50	25	24	24
Terrace	-	6,200	-	250	400	-	-	-	-
Paris	40' x 67'	2,700	9'	110	150	120	60	30	30