



## INTERCONTINENTAL

M I A M I

On Biscayne Bay, in the Financial District, adjacent to Bayside Marketplace, close to South Beach, Coconut Grove, and overlooking the Port of Miami. The property is 15 minutes from Miami International Airport, five minutes from the Port of Miami and minutes away from commercial and financial centers.

### InterContinental Miami

100 Chopin Plaza  
Miami, FL 33131

**Telephone:** .....305/577-1000  
**Reservations:** .....800/327-3005  
**Fax:** .....305/577-0384  
**E-mail:** .....miami@interconti.com  
**Web:** .....www.miami.interconti.com

### Guest Room Information

Number of rooms: ..... 641  
 Number of suites: ..... 34  
 Number of floors: ..... 34  
 Check-in time: ..... 4 p.m.  
 Check-out time: ..... Noon

Club InterContinental floors provide upgraded accommodations, private lounge for complimentary breakfast, snacks, cocktails, in addition to separate check-in and business center with boardroom.

Club InterContinental rooms cater to the business traveler with the following amenities: custom desk, computer dataport, ergonomic chair, custom task lamp, copier, fax and printer, two-line telephone, VIP treatment with bathrobes and complimentary coffee, complimentary toll-free numbers and local phone calls, movies on demand and HBO.

The 34-story hotel overlooks Biscayne Bay and the Port of Miami. Extra-large rooms feature video check-out, in-room movies, mini-bar, clock radio and individual climate control. In addition to 34 suites there are six executive suites, two bi-level suites, and the Royal and Presidential Suites.

### Meeting/Banquet Facilities

The hotel features 30 meeting rooms with a total of 66,000 square feet of space, including a spectacular ballroom, a 200-seat theater and an exhibition area on the mezzanine.

The hotel just finished a complete renovation of its 13,622-square-foot Grand Ballroom.

**Meeting Facilities:** Total area in square meters: 5,853.

**Meeting Equipment:** Portable stage, lectern/podium, stack chairs, easel, duplicating machine, stationery.

**Meeting Support Services:** Business center, concierge, photographer, multilingual in-house staff.

### Dining and Facilities

**Indigo Restaurant**—Featuring a world's fare lunch buffet, a sumptuous à la carte menu and Sunday Jazz Brunch. When planning a special event, consider one of our three private rooms for up to 90 guests, or the exclusive glass-encased Wine Room for parties up to 14. Breakfast 7 a.m.-11 a.m. Lunch noon-3 p.m. Sunday Brunch 11:45 a.m.-3 p.m. Dinner 6 p.m.-11 p.m.

**Indigo Bar**—Extensive beverage and "wine by the glass" selections in a cozy atmosphere. Featuring Miami's best happy hours and a Live DJ Thursday evenings. Open 11 a.m.-1 a.m. Happy Hour 5 a.m.-7 p.m.

**Miami Deli Center**—Located in the Miami Center Arcade. Open Monday-Friday from 7 a.m.-3 p.m.

**Blue Water Restaurant**—Where classic food, a comfortable setting and a dazzling view of Biscayne Bay call for a standing ovation. Ideal for a business lunch or a romantic dinner under the stars. Lunch noon-3 p.m. Dinner (Monday-Friday) 6 p.m.-10 p.m. Bar 10 a.m.-10 p.m. (from 6 p.m. on Saturday and Sunday.)

### Guest Services

24-hour room service, same day laundry/valet, business center, concierge, valet parking, multilingual in-house staff, photographer, car rental, handicapped facilities, voice mail, in-room coffee.

### Recreational Facilities

Beautifully landscaped fifth-floor terrace offers an outdoor pool and jogging track. State-of-the-art fitness center, sundeck.

### General Information

**Credit Cards Accepted:** American Express, Carte Blanche, JCB, Diners Club, MasterCard, Visa.

**Reservations:** Group space will be deemed definite upon receipt of signed group contract agreement.

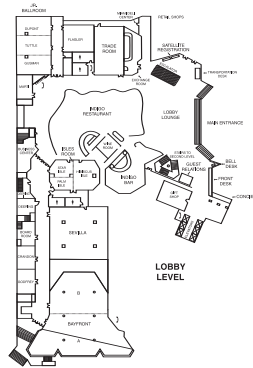
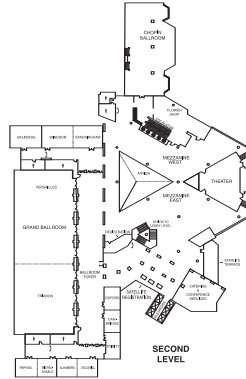

LOBBY LEVEL ROOM	BANQUET	RECEPTION	THEATER	CLASSROOM	HOLLOW SQ.	CONFERENCE
FLAGLER	60	100	80	36	32	20
JR BALLROOM	160	200	120	80	-	-
DUPONT	50	60	48	30	30	24
TUTTLE	50	60	48	30	30	24
GUSMAN	50	60	48	30	30	24
MARTI	20	25	24	18	-	16
DEERING	10	-	15	-	-	10
BOARDROOM	-	-	-	-	10	-
CRANDON	10	20	-	-	-	10
GODFREY	10	20	-	-	-	10
BAYFRONT A & B	450	700	450	240	80	60
BAYFRONT A	300	400	250	140	60	40
BAYFRONT B	150	300	180	100	46	36
SEVILLA	200	250	200	150	60	52
SECOND LEVEL ROOM	BANQUET	RECEPTION	THEATER	CLASSROOM	HOLLOW SQ.	CONFERENCE
ALHAMBRA & ESCORIAL	100	150	90	56	44	32
ALHAMBRA	50	75	45	28	22	18
ESCORIAL	50	75	45	28	22	18
RAPHAEL & MICHELANGELO	100	150	90	56	44	32
RAPHAEL	50	75	45	28	22	18
MICHELANGELO	50	75	45	28	22	18
OXFORD & CAMBRIDGE	60	60	-	-	-	-
OXFORD	30	30	30	18	18	18
CAMBRIDGE	30	30	30	18	18	18
TRINITY	30	30	30	18	18	18
GRAND BALLROOM	1,000	2,000	1,400	700	166	106
TRIANON	360	600	400	250	69	50
VERSAILLES	600	900	800	380	96	56
SANDRINGHAM & WINDSOR	100	150	130	75	60	50
SANDRINGHAM	50	75	70	32	30	26
WINDSOR	50	75	70	32	30	26
BALMORAL	50	75	70	32	30	26
THEATER	-	-	188	188	-	-
CHOPIN BALLROOM	400	500	450	240	72	56
MEZZANINE	1,000	2,000	-	-	-	-