



**J A M E S L.
K N I G H T**



**I N T E R N A T I O N A L
C E N T E R**

The Miami Convention Center's prime location is in the very heart of Downtown Miami. It is conveniently adjacent to the city's international financial district, Brickell Avenue, and many of the area's newest hotels. Within minutes are the Port of Miami and the Miami International Airport, as well as some of America's finest beaches.

**James L. Knight International Center/
Miami Convention Center**
400 SE 2nd Avenue
Miami, FL 33131

Telephone:305/579-6341
Fax:305/372-2919
City of Miami
Management Company:305/372-4633

Facility

Among the nation's most highly regarded convention and entertainment complexes, this is one of Greater Miami's most functional meeting, exhibit and entertainment venues. This major facility, designed to maximize convenience and flexibility, incorporates the University of Miami's Department of Conference Services and Professional Development, and the Hyatt Regency Hotel.

The center has 37 well-appointed meeting rooms, including a 444-seat auditorium and a 117-seat lecture hall, and can accommodate 20–5,000 people in a variety of configurations.

The James L. Knight International Center, a 5,000-seat auditorium with 16,000 square feet of exhibition space, is the only facility in South Florida with a fully integrated professional sound system. It meets the needs of the most demanding individuals and conventions. The Riverfront Hall, a 28,000-square-foot facility, is extremely unique and versatile overlooking the Miami River with the character of a luxuriously carpeted ball room. The hall is divisible into three separate sections of 4,000, 11,000, and 13,000 square feet. An attached 612-room Hyatt Regency Hotel offers an additional 23,000 square feet of meeting space. The University of Miami conference center offers a 444-seat auditorium, a 117-seat lecture hall and 14 variable meeting rooms. The Knight Center and Riverfront Exhibition Hall regularly host tradeshow, conventions, consumer shows, music rehearsals, concerts, plays, and community events.

The JLC is celebrating its 23rd anniversary of endless world-class events. Global Spectrum's assumption of management duties in 1997 demonstrated its ability to provide for a smooth transition of management responsibilities. It has hosted major events such as FTAA Congress for 2003. The venue is the major showcase in the South Florida market for Latin concerts (The nation's number three venue for Latin shows). Under Global Spectrum management, events have been reaching new record levels. The James L. Knight International Center is a favorite location for TV and radio production

companies. The Center has incorporated WIFI network through the building and web casting capabilities for any event.

A full complement of utilities includes fluorescent and incandescent lighting, electrical outlets, water services, fully distributed telecommunications access and drop acoustic-tile ceilings.

Guest Services

A broad array of services are available on-site, including complete teleconferencing facilities, language translations, audio/visual equipment, registration services and meeting planning services. Adjacent to the Center is parking for 1,450 cars.

The Center's in-house catering department and on-premise restaurants allow for creative flexibility in planning all types of themes and traditional events.

Management

Management Company – Global Spectrum
General Manager – Robert Murray
Director of Sales & Marketing – Manny Mora
tel:305/372-4633
fax:305/350-7910
www.jlkc.com

City of Miami

Executive Director, Christina Abrams
Marketing Manager, James Texas
tel:305/579-6341
fax:305/372-2919

Booking Inquiries & Information

Greater Miami Convention & Visitors Bureau
701 Brickell Ave., Suite 2700,
Miami, FL 33131800/933-8448
fax:305/539-3113
www.MiamiMeetings.com

Ita Moriarty,
Senior Vice President, Convention Sales
tel:305/539-3060

Mavie McHale,
Vice President, Convention Sales
tel:305/539-3070

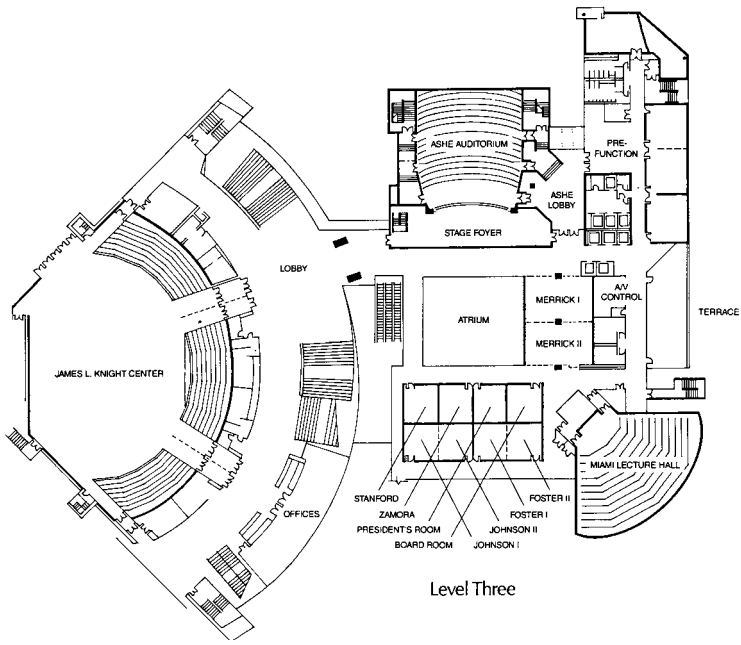

Level Three

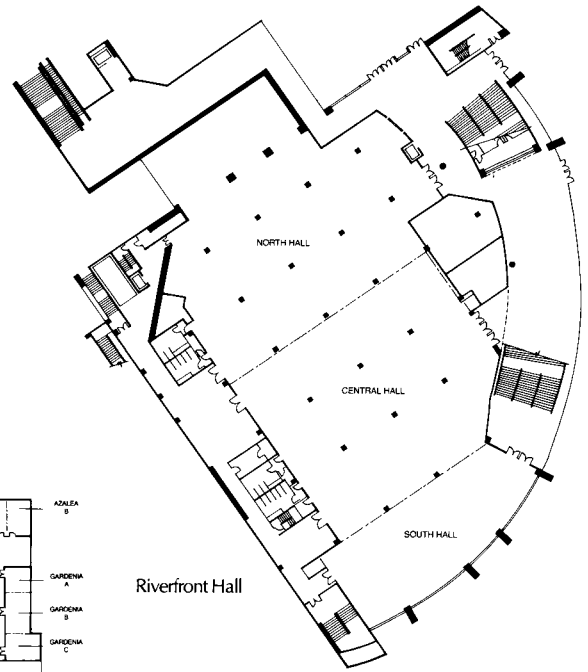

Riverfront Hall

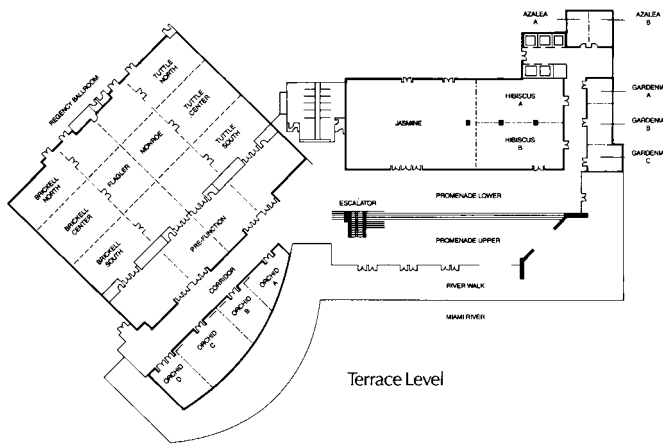

Terrace Level